

Tāiko

4 Bdrm / 278m²

If space is what you're after, this two-level home has ample — with four bedrooms and a generous open plan living area that opens out onto the deck. The well-appointed kitchen is ideal for entertaining no matter how many guests you're expecting. And the garage has extra space to keep the handyperson happy.

KEY FEATURES OF THIS HOME

- Weatherboard cladding
- Open plan living
- Sheltered entrance

 4 BEDROOMS

 4 LIVING ROOMS

 3 TOILETS

 2 BATHROOMS

 ✓ STUDY

 2 CAR GARAGE

 1 WALK-IN ROBE

 1 ENSUITE

 ✓ SEPARATE LAUNDRY



See floor plans on reverse



Always check the LBP Register to ensure your building practitioner is licensed.

Certified Plans are brought to you by New Zealand Certified Builders.

www.certifiedplans.co.nz

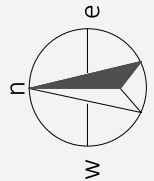

Elevation Guide

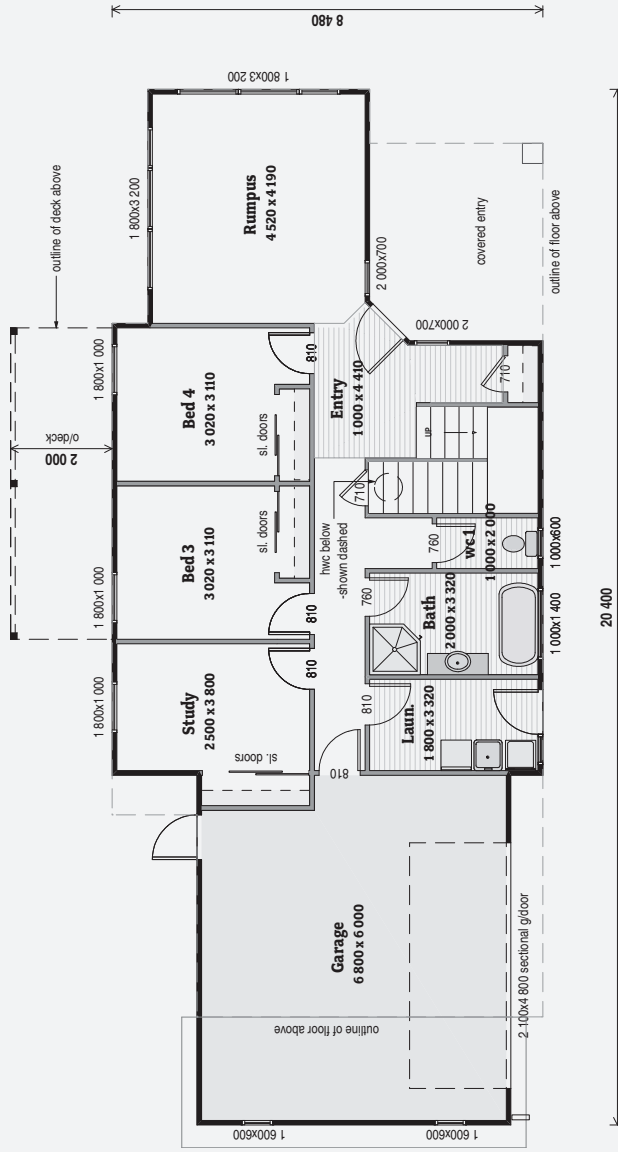

Ground Floor Area
137.5m² o/frame

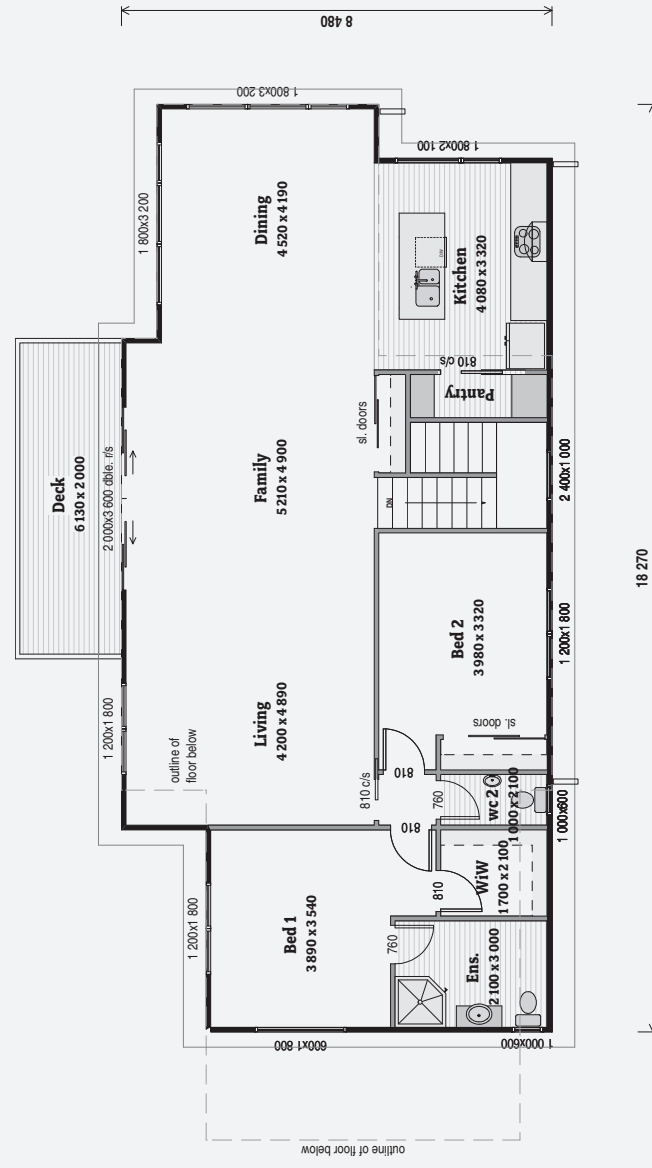

First Floor Area
141.4m² o/frame